



CABLE TIE INSTALLATION TOOL

Part No.: GTS (Mil. Std. MS90387-1),
and GTSL

FOR INSTALLING:

PAN-TY, DOME-TOP Barb Ty, STA-STRAP,
CONTOUR-TY*, and In-Line Cable Ties of Subminiature,
Miniature, Intermediate, and Standard cross sections.

MADE IN USA

TOOL MAINTENANCE: GTS, GTSL

These tools require no special operator maintenance.

REPLACEMENT KITS/ACCESSORIES:

(Sold Separately)

D: KGTSTL – Tension Locking Kit

E: KGTSBLD – Blade Replacement Kit

F: WB23932C01 – Replacement Blade Guard

F: WB24468D01 – Optional Blade Guard *CONTOUR-TY

G: KGTSSLV – Grip Sleeve kit (for GTS only)



GTS, GTSL

PA23960A01

Rev. 06 10-2008

OPERATING INSTRUCTIONS

© Panduit Corp. 2008

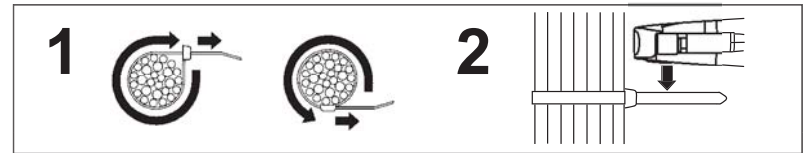

GTS Tool Shown

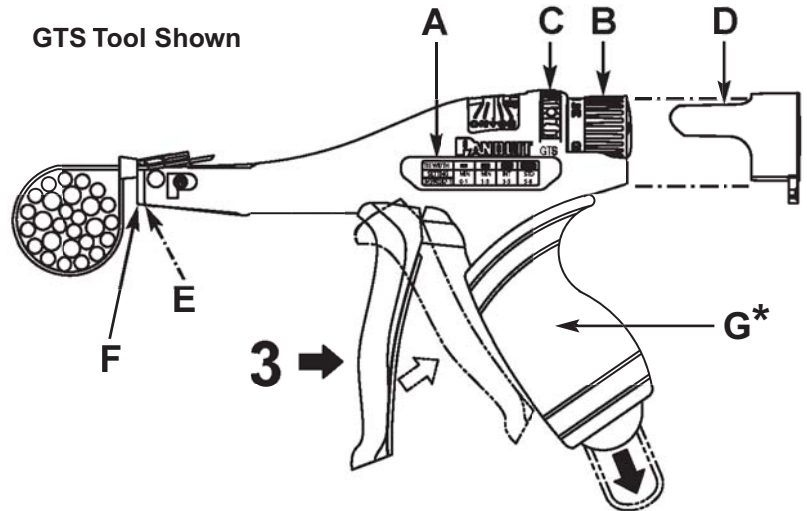

* NOTE: Item G - KGTSSLV
Not recommended for use with GTSL

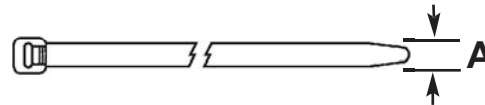

A	SUBMIN .070" (1.8mm)		MIN .098" (2.5mm)		INT .142" (3.6mm)		STD .190" (4.8mm)	
<								